

HELICAL GEAR PUMP
 KHP SERIES

KHP½"

Ports	½" Pipe Thread 180° PN16
Pressure	2-14 bar
Flow Rate	0,006
Max Flow	0,54 m3/h
Max Speed	1500 rpm
Viscosity Range	100 – 25,000 Cp
Temperature	20-200 °C
Body Material	Pig Iron (GG25) / Stainless St (AISI316)
Shaft Material	1040 Steel (AISI1040) / Stainless St (AISI316 / AISI420)
Gear Material	Pig Iron (GG25) / Stainless St (AISI316)
Bushing	Bronze / Carbon Aided Teflon
Sealing	Yumuşak Salmastra / Mekanik Salmastra
Accessories	Filtre
Weight	5,5 KG

ADVANTAGES

- ▶ High speed
- ▶ Good for relatively low viscosity
- ▶ Relatively quiet operation
- ▶ Operates well in either direction
- ▶ Easy maintenance

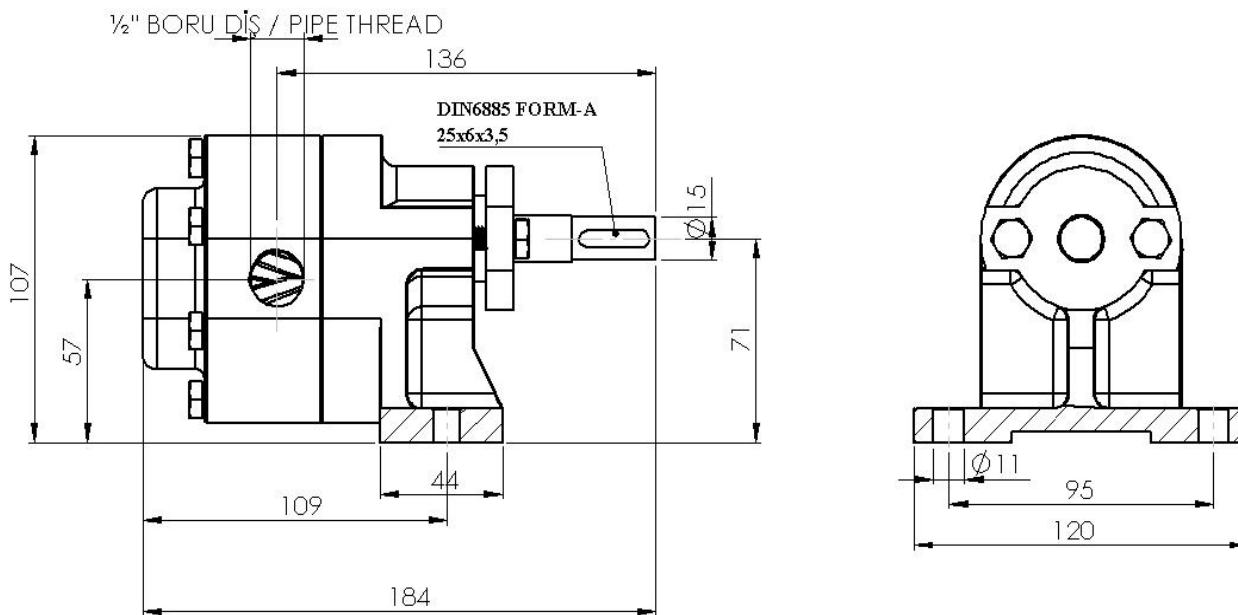
DIMENSIONS

KHP½" HELICAL GEAR PERFORMANCE CURVES

1- Speed - Flow

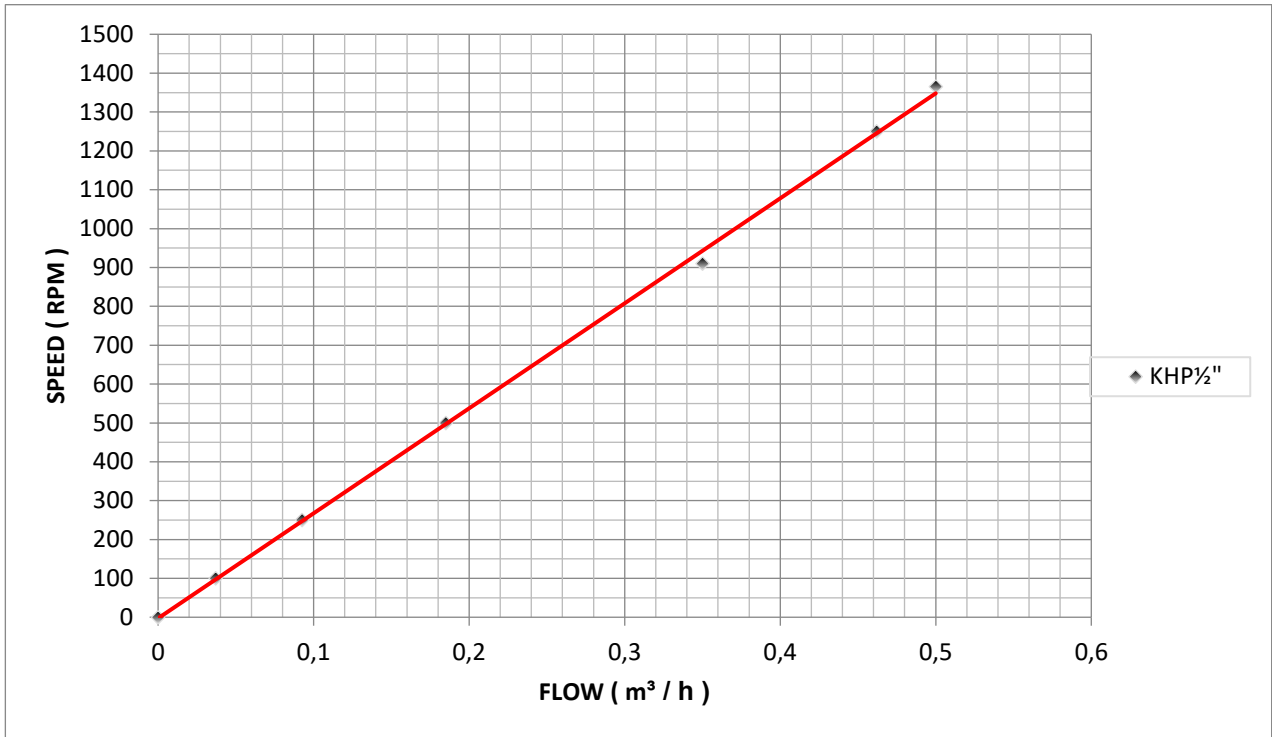

2- Speed - Power - Pressure

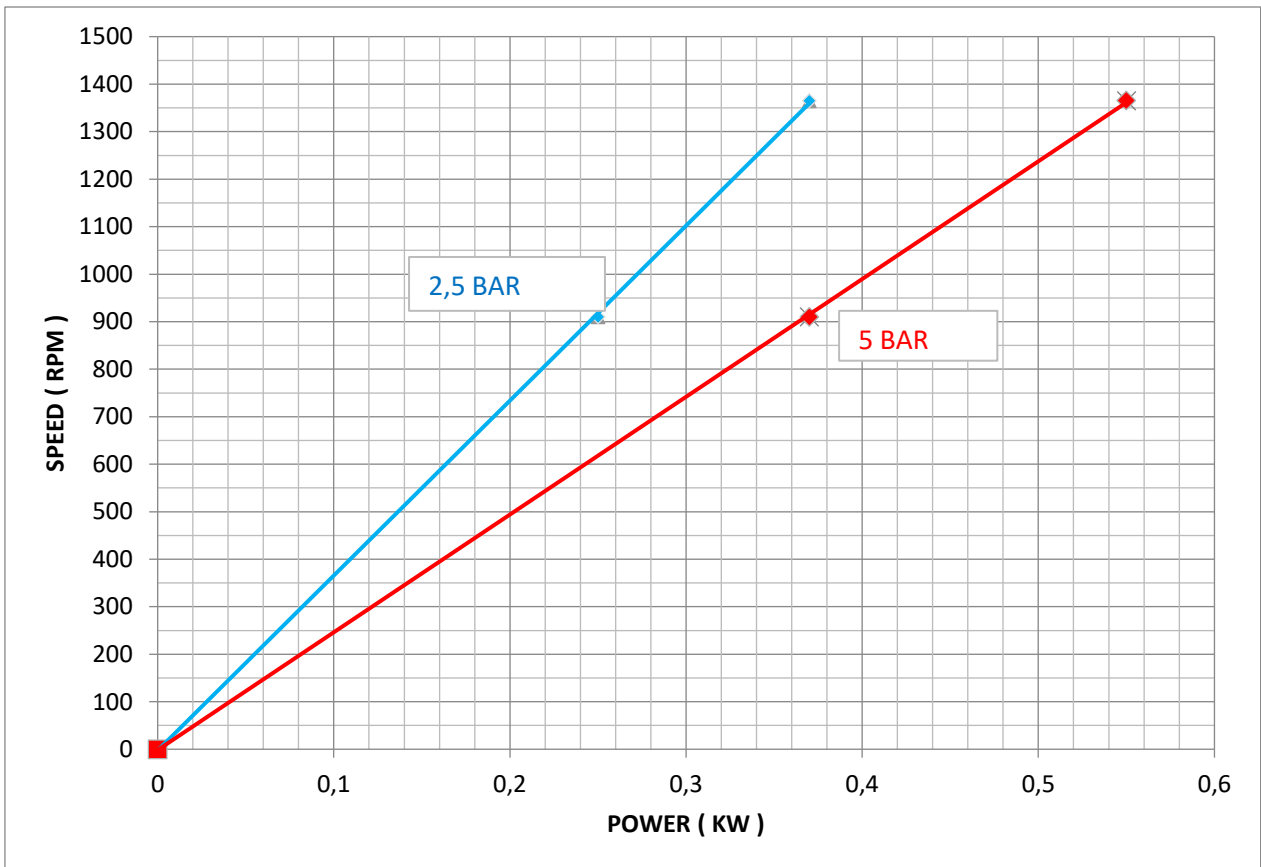

TESTS HAVE BEEN DONE WITH SAE30 OIL AT ROOM TEMPERATURE (APPROX. 100 CST)